

LANDING GEAR GROUP - Figure 2. Tail Wheel Installation

See Controls Group - Figure 13 & 14 for Optional Manual Tail Wheel Lock Installation

Item	Part Number	Description	Qty
1	40117-1	Tail Gear Fork Assembly	1
2	40154-1	Lock Bushing, Tail Wheel	1
3	MS24693C273	Screw	2
4	AN860C10	Washer, Flat	10
5	MS21044C3	Nut, Self Locking	3
6	40118-1	Tail Wheel Housing Assembly	1
7	40115-1	Seal, Tail Gear	1
8	91089-1	Cone, Bearing	1
9	91088-1	Cup, Bearing	1
10	40124-1	Bushing, Upper	1
11	40150-1	Shim, Tail Wheel Housing	Optional
12	40119-1	Pin, Arm Assembly	1
13	AN80C24	Bolt, Alt. (4011-1)	1
14	AN80C24	Washer, Flat	2
15	MS21044C3	Nut, Self Locking	1
16	AN80C24	Bolt	10
17	AN860C16	Washer, Flat	4
18	AN860C16	Washer, Spring Attach	4
19	40035-1	Bracket, Spring Attach	1
20	40036-1	Bracket, Spring Attach	1
21	MS21044C4	Nut, Stainless Self Locking	6
22	MS15001-1	Fitting, Grease	2
23	NAS1102E4-14	Screw	4
24	40025-7	Lock Pin Housing Assembly	4
25	40131-1	Locking Pin	1
26	40082-1	Spring, Lock Pin	1
27	40019-1	Pin, Arm Assembly	2
28	AN870C4	Washer, Large Area	1
29	AN870C3	Bolt, Castalloy	1
30	AN870C3	Nut, Castalloy	1
31	MS24665-151	Pin, Cotter	3
32	40112-1	Trigger Assembly, Tail Wheel Lock	1
33	AN8C10A	Bolt	1
34	40114-1	Bushing	1
35	40110-1	Spring, Trigger	1
36	MS20392-2-21	Pin, Clevis	1
37	AN860-816	Washer, Flat	6
38	71144-1	Cable Assembly	1
39	MS20392-2C13	Pin, Clevis	1
40	71141-1	Rod Assembly	1
41	AN316-4	Nut	1
42	MS21261-855	Strut, Turnbuckle	1
43	MS20993C32	Spring, Wire	1
44	40156-1	Spring, Centering	2
45	71143-1	Cable Assembly, Tail Wheel Spring Safety	1
46	51248-1	Upper Cable Guide Assembly, Tail Wheel Lock	1
47	51248-1	Clamp	2
48	AN4-16A	Bolt	2
49	AN860-416	Washer, Flat	2
50	AN365-428	Nut, Self Locking	2
51	40092-8	Spring	1
52	NAS154DH-32	Bolt, Internal Wrenching	2
53	MS20002C14	Washer, Large Area	2
54	70122-2	Fairlead (Pipe)	2
55	71137-1	Lower Cable Guide Assembly, Tail Wheel Lock	2
56	40081-2	Strap Ring (Pipe)	1
57	40097-2	Check, Spring Attach	1
58	40146-1	Bracket, Spring Attach	1
59	40149-1	Pad, Tail Gear Spring	2
60	NAS148-73	Bolt	1
61	MS20002C8	Washer, Flat	2
62	3088A322	Shim - 1/2 x 3/4 x .010 (McMaster Carr)	2
63	52N1610-080	Nut, Self Locking (alt. F52N1610-80)	4
64	NAS31309-34	Bolt	1
65	AN365-820	Nut, Self Locking	1
66	AN7C84A	Bolt	1
67	40134-1	Axle Assembly, Tail Wheel	1

Landing Gear Group - Page 2 (AT-802/802A) Date: 1/19

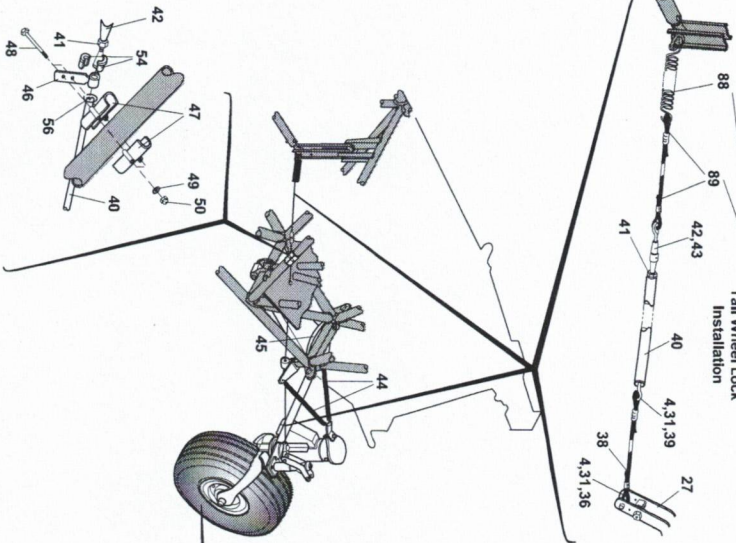

Note:
 * In item number column indicates Cleveland Part Numbers which are supplied by Cleveland Wheels and Brakes, Avon, Ohio 44011
 ** In item number column indicates parts that are omitted when Optional Manual Tail Wheel Lock is installed

Item	Part Number	Description	Qty
* 68	40-428C	Tail Wheel Assembly (Cleveland) (Items 68-79)	1
69	154-13500	Seal, Grease	2
70	214-01200	Cone, Bearing (Alt. 13889 (Trinkl))	0
71	214-01100	Cup, Bearing (Alt. 13889 (Trinkl))	0
72	067-14600	Washer, Flat	1
73	182-18906	Wheel Nut Subassembly, Inner	1
74	103-20200	Wheel Nut Subassembly, Outer	6
75	095-10500	Washer, Flat AN860-516	12
76	094-10401	Nut, Self Locking: MS21045-5S	2
77	155-14300	Strap Ring	2
78	166-19700	Name Plate	1
79	166-20000	Name Plate, "Warning"	1

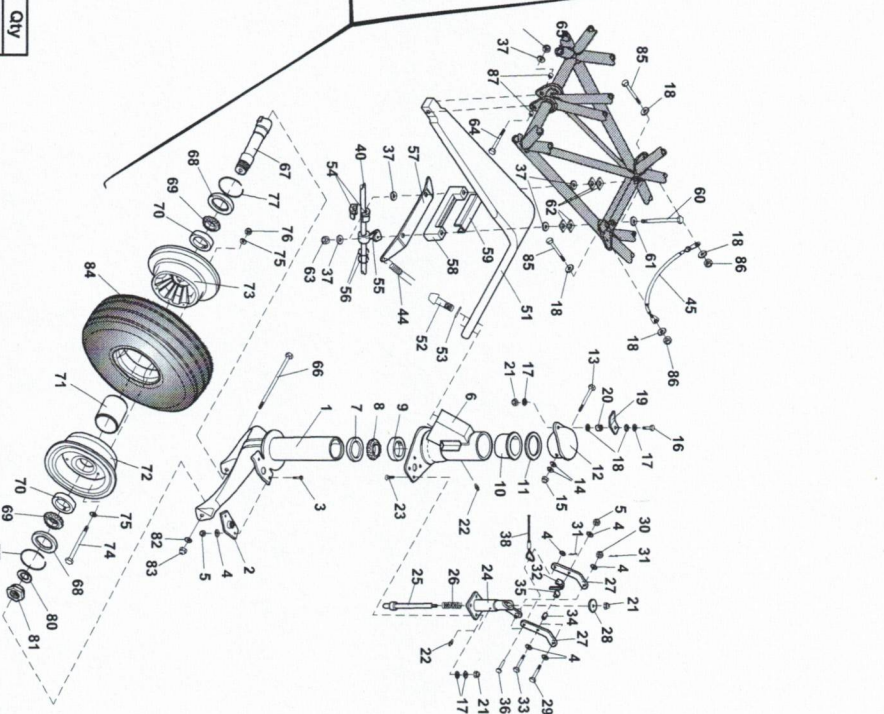

Item	Part Number	Description	Qty
80	40138-1	Washer, Tongue	1
81	40139-1	Nut, Tail Wheel Axle	1
82	AN80C16	Washer, Flat	1
83	MS21044C3	Nut, Self Locking	1
84	173-2100-6	Tube - (Specialty) Tire Air Hawk	1
85	AN8C13A	Bolt	1
86	MS21044C6	Nut, Self Locking	1
87	11067-1	Spring (International Harvester)	2
**88	54548-D	Bushing, Spring Attach Fwd	2
**89	71145-1	Cable Assembly, Tail Wheel Lock	1