

#	Date	Revision	Name
0	05/01/2024	Diseño Original.	DM
1	30/03/2026	Se ajuste largo de barra por cambio de acople	DM

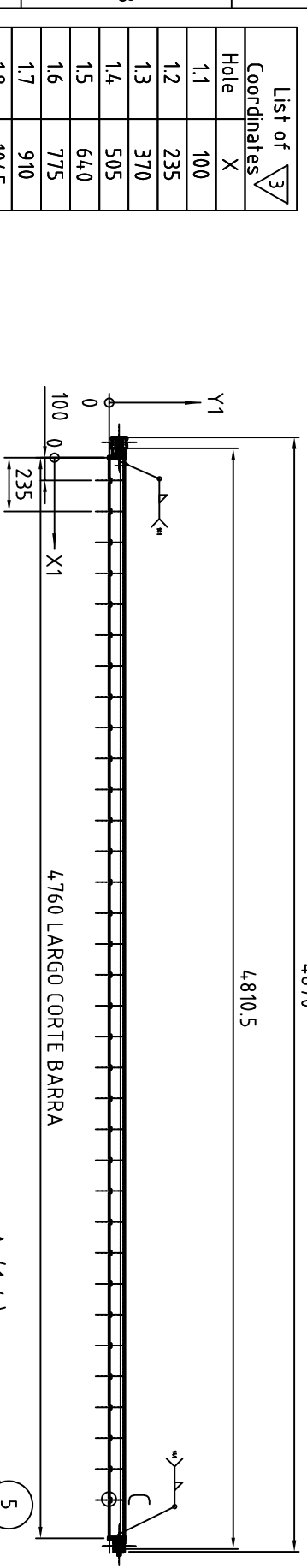

List of Coordinates	
Hole	X
1.1	100
1.2	235
1.3	370
1.4	505
1.5	640
1.6	775
1.7	910
1.8	1045
1.9	1180
1.10	1315
1.11	1450
1.12	1585
1.13	1720
1.14	1855
1.15	1990
1.16	2125
1.17	2260
1.18	2395
1.19	2530
1.20	2665
1.21	2800
1.22	2935
1.23	3070
1.24	3205
1.25	3340
1.26	3475
1.27	3610
1.28	3745
1.29	3880
1.30	4015
1.31	4150
1.32	4285
1.33	4420
1.34	4555

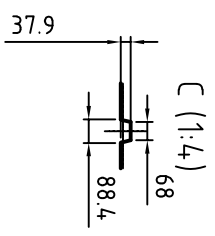
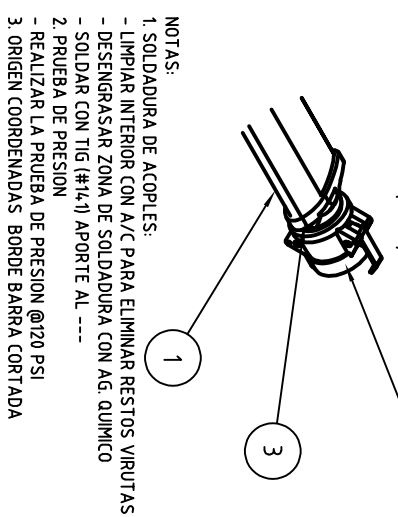
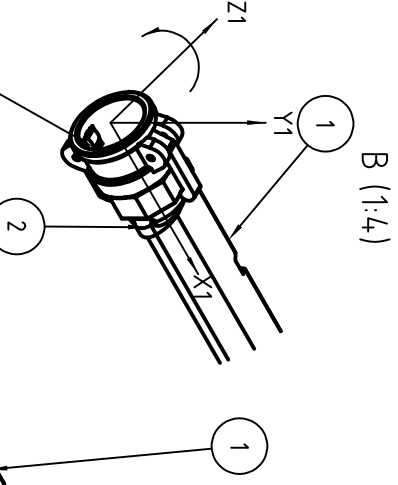

▽ TIG 14.1
- CORRIENTE ALTERNA
- BALANCE: 30/70 (E/MIL SYNCROWAVE 351: 90%)
- H/F: 100 HZ
- AMP: 120
- ARGON: 15 CF/H
- GRATER FILL ON / TIME: 2 SEC
- PREFLOW: 15 SEC
- POSFLOW: 3 SEC

Item	Qty	P/N	Descripción	BLK Material	Proveedor	Material
1	1	80307-PI-AR	Acople Interfase 1-1/2"	R2" x 4.5 + S	MMetal SRL	AL 6061 T6
2	1	80307-PI-AR	Acople Interfase 1-1/2"	10.0x75x32	MMetal SRL	AL 6061 T6
3	1	80307-PIZ-A R	Acople Interfase 1"	10.0x15x32	MMetal SRL	AL 6061 T6
4	1	DGH038AL	Acople Rápido DCH 1-1/2" AL	R2" x 4.5 + S	Ind. Dica SRL	AL 6061 T6
5	1	DC035PP	Acople Rápido DC 1" Palp.	Comercial	Ind. Dica SRL	Poliprop ileno

FILE NAME	80307-IRH-AR.dwg	FSCM NO	
SIZE	A3	SHEET	1/1
DRAWN	05/01/2024 DM		
CHECK			
APPR.			
ISSUED			
REV	1		
CONTRACT NO			

Sistemas de Fumigación	
Barra Fus. Aluminio Der.	
Plano de Conjunto	
DWG NO	80307-1RH-AR